

(1) SMR Code	(2) Federal Stock Number	(3) Description	(4) Unit of Meas.	(5) Qty	(6) 15-day Maintenance In	(7) Organizational alw Illustration	(a) Figure No.	(b) Item No.
Reference number & mfg. code			Usable on code		(a) (b) (c) (d)			
0504-WATER PUMP-CONTINUED								
PAOZZ	4730-769-7737	VALVE: WATER DRAIN, PUMP 7697737 (19207)	AC	EA	1	* * * *	47	11
PAOZZ	4730-890-2371	ADAPTER: AIR COMPRESSOR, COOLANT HOSE CONNECTOR TO PUMP 63AX1842 (76040)	AC	EA	1	* * * *	47	12
PAOZZ	4730-890-2373	CONNECTOR: AIR COMPRESSOR, COOLANT HOSE TO ADAPTER 63AX308 (76040)	AC	EA	1	* * * *	47	13
PAOZZ	5305-042-6417	SCREW, CAP, HEXAGON HEAD: 1/2-13UNC-2A X 1 1/2 LG PUMP MOUNTING MS90725-113 (96906)	AC	EA	2	* * * *	47	14
PAOZZ	4720-974-7488	HOSE ASSEMBLY, NONMETALLIC: COMPRESSOR COOLANT RETURN 36RUA3132946 (76040)	AC	EA	1	* * * *	47	15
PAOZZ	2930-974-7489	HOSE ASSEMBLY, RUBBER: COMPRESSOR COOLANT INLET 36RUA3132P9 (76040)	AC	EA	1	* * * *	47	16
PAOZZ	4730-890-2372	ELBOW: AIR COMPRESSOR, COOLANT HOSE AT CYLINDER 63AX1214 (89619)	AC	EA	1	* * * *	47	17
PAOZZ	2930-974-7543	GASKET: WATER PUMP MOUNTING 194215 (19207)	AC	EA	1	* * * *	47	18
PAOZZ	4730-890-2370	PLUG: OIL DRAIN, 1/4 NPT PUMP BODY 63AX4 (89619)	AC	EA	1	* * * *	47	19
PAOZZ	2910-974-7581	REDUCER: FUEL FLOW, GREASE POCKET BREATHER 63AX1221 (76040)	AC	EA	1	* * * *	47	20
PAOZZ	2520-692-5887	BREATHER: GREASE POCKET REDUCER 7764064 (19207)	AC	EA	1	* * * *	47	21
PAOZZ	2930-903-0679	PARTS KIT, WATER PUMP DRIVE: 5702725 (19207) CONSISTING OF: 1-PUMP: 10951101 (19207) 1-GASKET: 10889854 (19207) 1-WASHER: MS35333-41 (96906)	AB	EA	1	* * * *	46	KIT
0505-FAN ASSEMBLIES								
PAOZZ	5305-225-9081	SCREW, CAP, HEXAGON HEAD: 5/16-18UNC-2A X 1 1/4, FAN TO PUMP MS90725-36 (96906)	AA	EA	6	* * * *	48	1
PAOZZ	5310-407-9566	WASHER, LOCK; 5/16 NOM SIZE, FAN TO PUMP MS35338-45 (96906)	AA	EA	6	* * * *	48	2

TA 009228

Current part is item (1) on diagram. Available at [www.oshkoshequip.com](http://www.oshkoshequip.com)

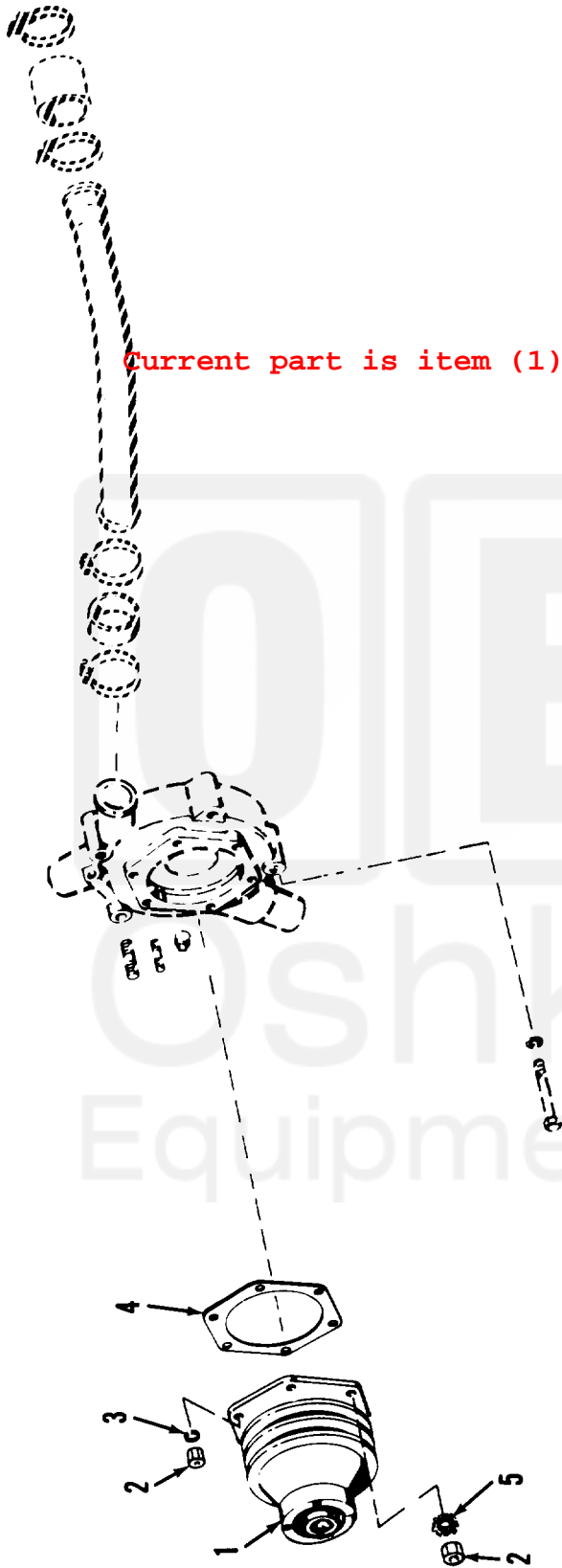

Figure 16. Water pump and related parts (multi-fuel).

Current part is item (1) on diagram. Available at [www.oshkoshequip.com](http://www.oshkoshequip.com)